

*In order to achieve the highest-quality images possible, Cognex® offers a wide variety of light modules. The LED array light module is designed for use in typical bar light applications, including front, angle, and multiple-angle lighting (for feature highlighting). The LED Array light module is available in red, white, and IR models. Additionally, an optional diffuser enhances this light module's front lighting performance, and also allows it to be used as a backlight.*



## Models

- White LED Array Module: Model IDWA
- IR LED Array Module: Model IDIA
- Red LED Array Module: Model IDRA

## SPECIFICATIONS

### Mechanical

#### LED Array

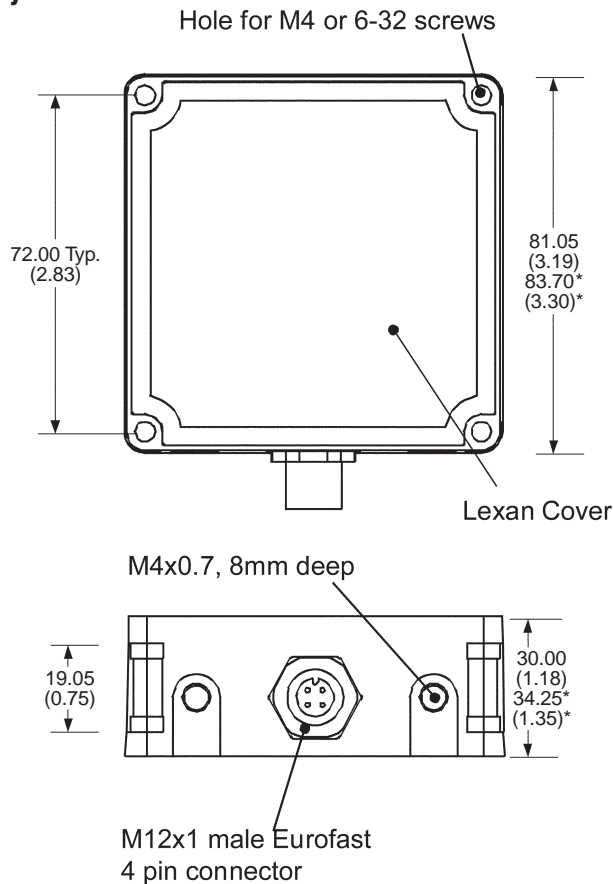

#### Notes:

1. All measurements are provided in millimeters (first number) and inches (number in parenthesis)
2. Light module shown without optional diffuser installed

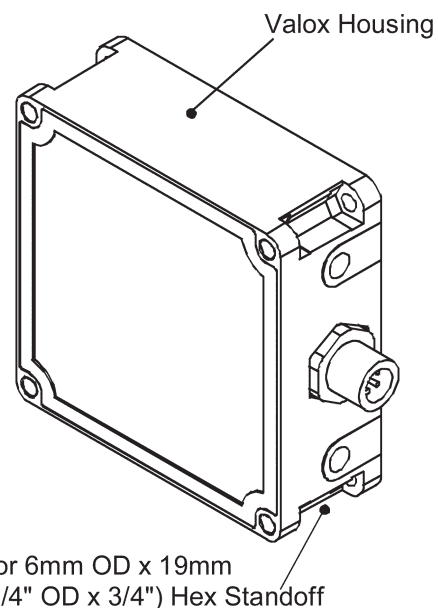

\*With optional diffuser installed

## Electrical

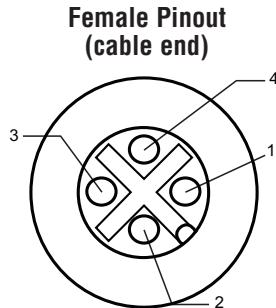

Wire Color	Pin Number*	Function	Breakout Boards		
			CON-IBOB (500 Only)	CON-BRK (600 Only)	In-Sight® CIO-1350/1450
Brown	1	+ 24V	24V	16: V+	24VDC
White	2	No connection	N/A	No connection	N/A
Blue	3	Ground	GND	15: GND	GND
Black	4	Strobe Input signal	IO8	14: or 17-20: IO12	High-speed Output (0/1)

\*See figure at left for this numbering scheme

LED Color	Wavelength	Light Part Number	Max Current	Max Duty Cycle	Max Average Current
Red	670nm	IDRA	1.25 A	15%	188 mA
Infrared	850nm	IDIA	4.5 A	5%	225 mA
White	Not Applicable	IDWA	1.1 A	15%	165 mA

\*General characteristics: Voltage Supply = 24V, Trigger Voltage = 15V, Max single pulse = 50ms

## OPTIONAL ACCESSORIES

### LED Light Bracket (P/N ID0A-BR)

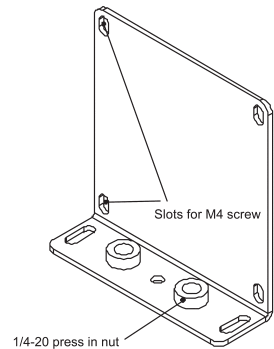
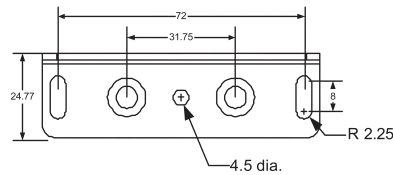
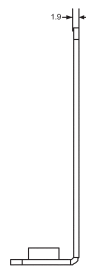
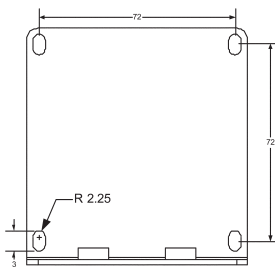

Note: All units in millimeters.

Optional Accessory	Description	Part Number
Standoffs/ Screws	Hex Standoffs and screws for LED Array mounting. Includes four 3/4" long 6/32 hex threaded standoffs and four 3/4" long 6/32 socket head screws.	ID0A-SE
LED Array Module Cable	6-meter (19.7ft) pigtailed cable, M12 connectors with bare wire ends	CBL-P18
LED Array Module Diffuser	51mm (2 in) diffuser for all models	ILC-605