

This document contains information proprietary to Cognex Corp., Natick, MA. The information is not to be used in any way, disclosed to others, or reproduced, in whole or in part, except as expressly authorized by Cognex. Any reproduction of this document in whole or in part, even when authorized, must include this notice.

REVISIONS			
REV	DESCRIPTION	DATE	APPROVED
A	RELEASED PER ECO 04-355	9/8/04	MP

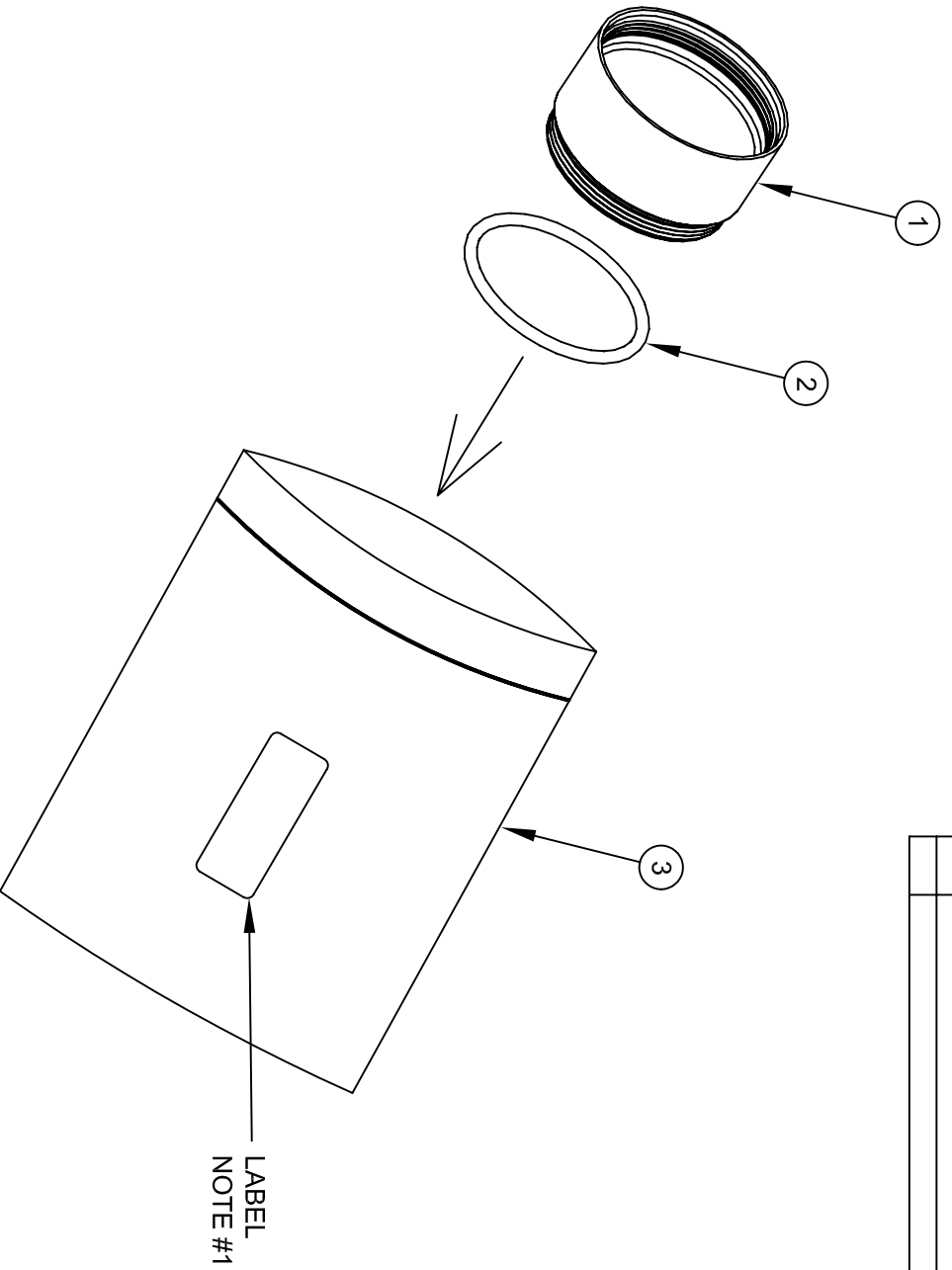

- NOTES:
1. LABEL SHOULD INCLUDE P/N AND REVISION ACCORDING TO CURRENT WORK ORDER. USE AVERY LABEL #5167 (1/2"x1 3/4") OR EQUIVALENT.
 2. ZIP-LOCK SEAL THE BAG AFTER THE LENS EXTENSION IS PLACED INSIDE.

CONFIDENTIAL & PROPRIETARY		COGNEX <i>Vision for Industry</i>		NATTICK, MA 01760	
TOLERANCES		IN-SIGHT SXXX		DATE	
XXX	± .01	LENS EXTENSION KIT		9/8/04	
XXXX	± .005	DRAWN BY		DWG NO.	
ANGLE	± .5 DEG	DICKINSON		D800-5851-X	
APPROVED BY		SCALE:		SHEET 1 OF 1	

4 3 2 1